

# Introducing LEGO® Education WeDo 2.0

Making Science and  
Programming Come to Life

Attention: Primary School Science  
& Digital Technology Teachers



## An Introductory Hands on Workshop

Linked to the Australian Science and the new Digital Technologies Curriculum

This workshop session is designed to be hands on, encourage collaborative learning and to have some fun.

Teachers attending this workshop will:

- Be introduced to the WeDo 2.0 hardware through quick build models exploring the use of motors & sensors.
- Program using the WeDo drag and drop software which provides an integrated learning experience.
- See how students can add text, images & video to create & present projects.
- Explore the Australian curriculum material available to match your needs & requirements in the classroom. Years 2–6.

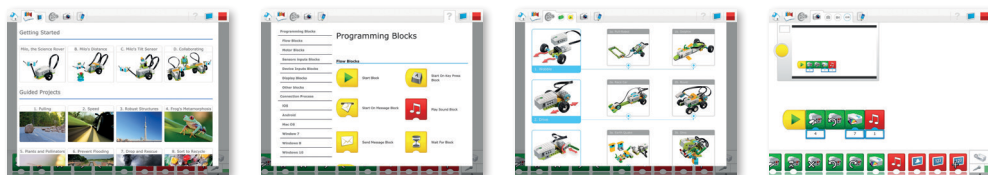

## About the Presenter



**Joanna Burk** has worked with LEGO® Education resources since 1998. She has a Diploma of Teaching in Primary Education & Certificate IV in Workplace Training & Assessment.

In her current role as Business Development Manager - STEM & Robotics with MTA, Joanna conducts professional development workshops for teachers in the effective use of LEGO Education & Robotics resources.

Joanna is also trained and certified in the application of the world renowned LEGO Serious Play methodology and is able to facilitate team and strategy sessions to ensure that all participants actively engage with the process.

Her presentations at curriculum days, workshops, information sessions, conferences & network meetings provide participants with a wealth of information which will assist in achieving best practice in teaching.

Joanna is also an actively involved member with Robocup Junior competitions in Australia & New Zealand.

## Workshop Details

**When:**

**Wednesday March 6th 2019**  
**1.00pm – 4.00pm**

**Where:**

Panania Public School  
23 Lawler St,  
Panania NSW 2218

**Workshop Fee:**

\$79.00 including GST

**Maximum 3 teachers per school.**

Light snacks will be provided

To register for this workshop please email [workshops@teaching.com.au](mailto:workshops@teaching.com.au) or fax bookings to (02) 9938 0495

An email will be sent to confirm your booking.

<b>School:</b>	<b>Post Code:</b>	<b>Special Dietary Requirements</b>
<hr/>	<hr/>	
<b>Participant Name:</b>	<b>Email:</b>	<input type="checkbox"/> Yes <input type="checkbox"/> No
<hr/>	<hr/>	
<b>Participant Name:</b>	<b>Email:</b>	<input type="checkbox"/> Yes <input type="checkbox"/> No
<hr/>	<hr/>	
<b>Participant Name:</b>	<b>Email:</b>	<input type="checkbox"/> Yes <input type="checkbox"/> No
<hr/>	<hr/>	

All enquiries please email [workshops@teaching.com.au](mailto:workshops@teaching.com.au). Bookings are essential as numbers are limited. No refund for last minute cancellations. Visit us online at [teaching.com.au](http://teaching.com.au)

MTA ABN: 98000628786. If you don't wish to receive further emails or faxes from MTA please email [workshops@teaching.com.au](mailto:workshops@teaching.com.au) or fax back opt out faxes.